

# 9009 *User Guide*

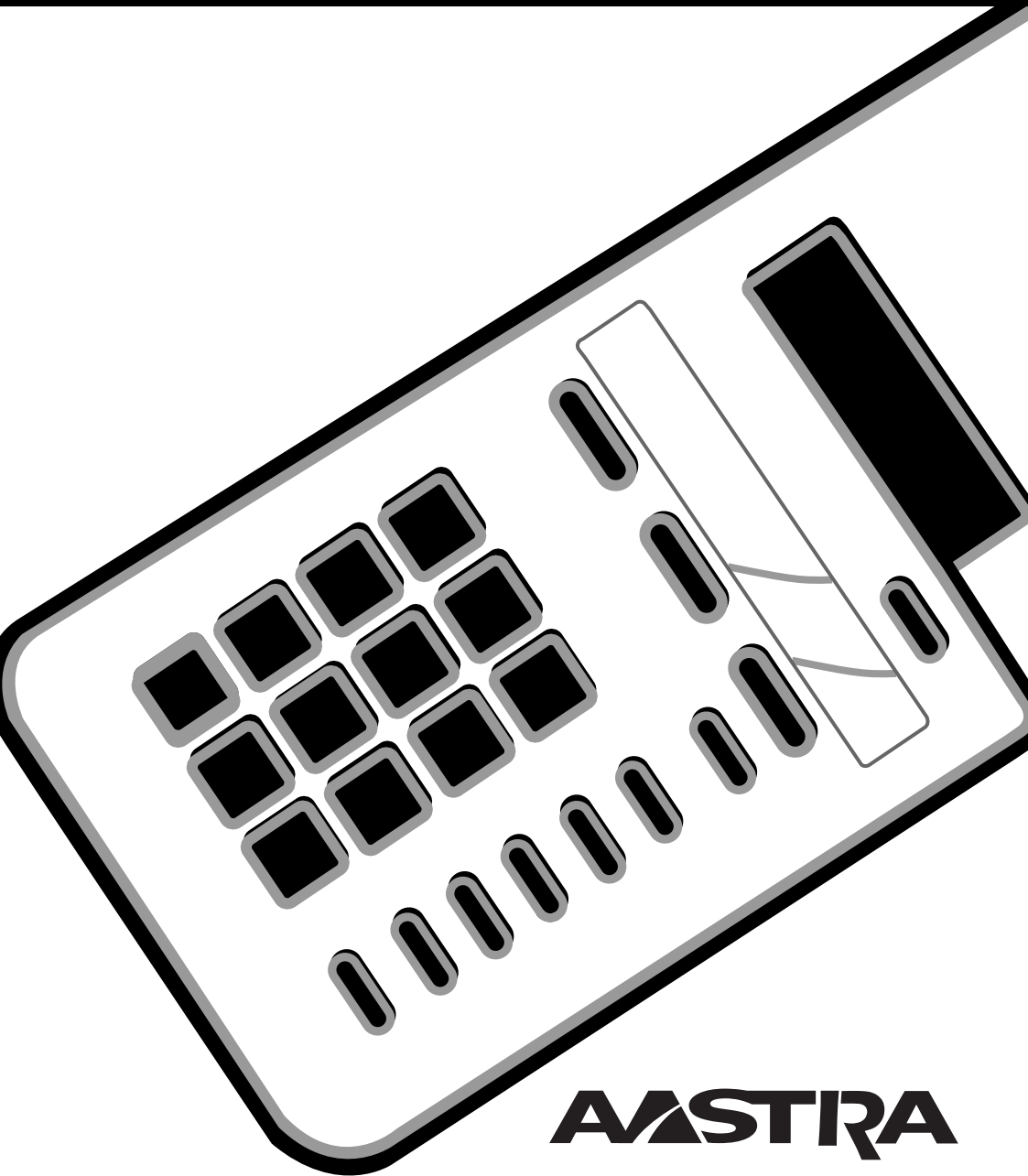

**ASTRA**



# Table of Contents

<b>The 9009 - Introduction</b>	<b>1</b>
<b>Installing your 9009</b>	<b>2</b>
<b>Checking your phone</b>	<b>5</b>
<b>Personalizing your phone</b>	<b>6</b>
Options	6
To change any of the five options	6
<b>Saving numbers and services in memory</b>	<b>7</b>
To save a number in memory	7
To erase the contents of a memory key	7
To program a Call Forwarding ON key	7
To program a Call Forwarding OFF key	7
<b>Using the 9009 features</b>	<b>8</b>
Protecting the contents of your memory keys	8
Placing a customer on hold	8
Ensuring privacy	8
Controlling the ringer volume	8
Controlling the receiver volume	8
Releasing a call	8
To unlock your memory keys	8
Pause Feature	9
Remembering the last incoming call	9
<b>Light and display messages</b>	<b>9</b>
Using telephone company services	9
Knowing when you have a message	9
Light and Display	9
What it means	9
<b>Answering your questions</b>	<b>10</b>
<b>Index</b>	



# **The 9009 telephone...simplicity at work**

## **Taking care of your business**

In today's competitive marketplace, you need a business tool that will help you stay in touch with your customers. This business telephone will give you the features of a large office system, but is as affordable and easy to use as a small office telephone.

## **The 9009 puts new features to work**

Your 9009 telephone works with the new and powerful call management services and supports Centrex features. The phone also works with the new messaging services available as telephone company subscriber services or as an optional Centrex system feature.

## **The 9009's display guides you step by step**

Perhaps the most exciting feature about your 9009 telephone is the display that provides messages to guide you step by step through any function. Just read the display for instructions on making or receiving calls and using features.

## **A new point of view**

Answering the phone doesn't have to be a surprise. The 9009's display lets you see who's calling before you answer the phone. If you subscribe to Call Display†/Caller ID†, the caller's telephone number (and name, if available) appears on the display as your phone is ringing.

## **Discover the 9009**

The Discovery Card lets you use your new 9009 telephone right away. This learning tool tells you what the keys do and how to use them. Experiment by pressing various keys and reading the display. Use the Discovery Card for a few days until you become familiar with the many features of your new phone.

†Until you subscribe to Call Display or Caller ID (not available with PBX), or until your Centrex system provides a Call Display/Caller ID feature, the number (and name, if available) of the call will not appear on the display. The name for this service may differ in your calling area.

# Installing your 9009

1. Connecting the receiver and receiver cord. 

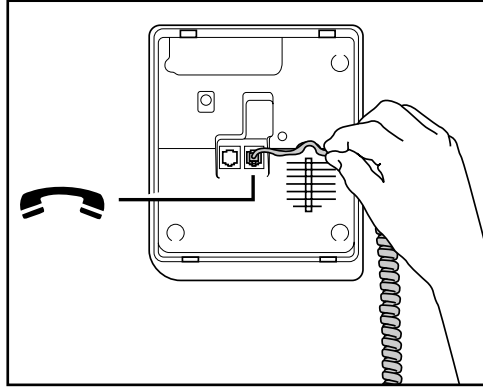

2. Stand (desk-mount or wall-mount).

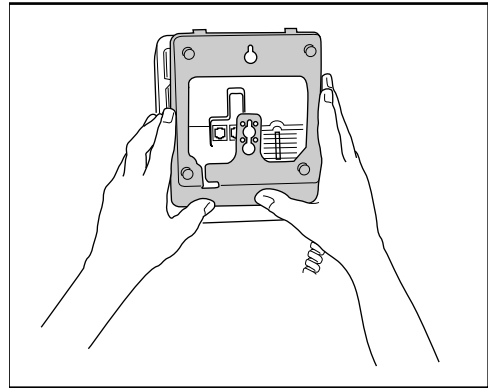
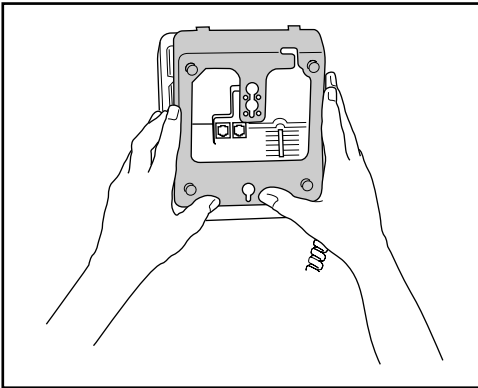

Attach the wedge-shaped stand in desk-mount or wall-mount (see Figure 8) position.

3. Connect the line cord. 

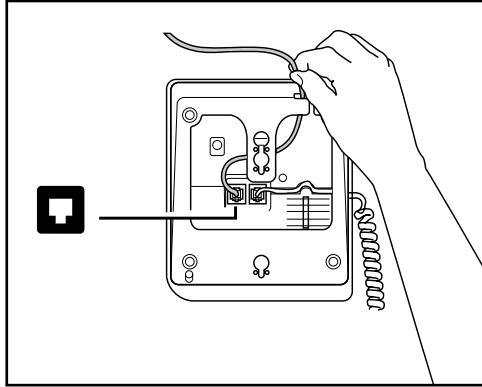

4. Connect the power adapter cord. 

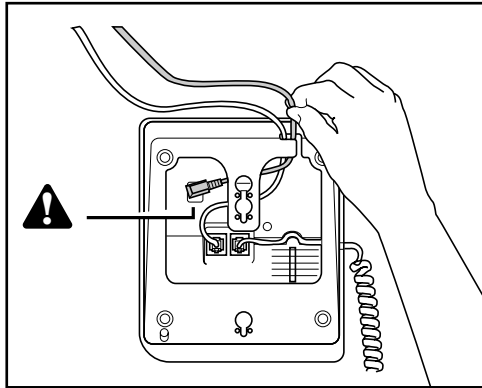

5. Attach the faceplate.

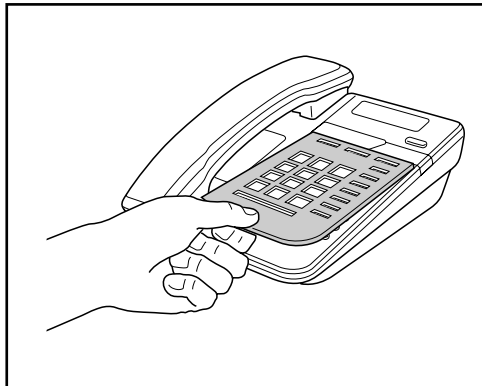

**6. Attaching Receiver Card and lens.**

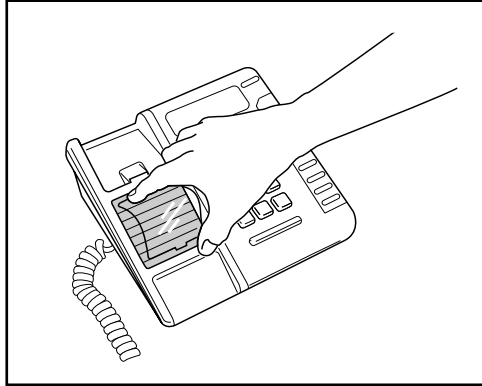

**After saving numbers in memory, attach the Receiver Card and lens (shiny side down).**

**7. Fitting the Discovery Card.**

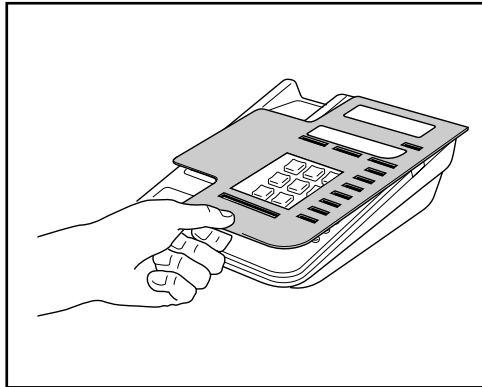

**Place your phone on a desk. Then fit the Discovery Card over the keys on the phone.**



## 8. Wall Mount Only.

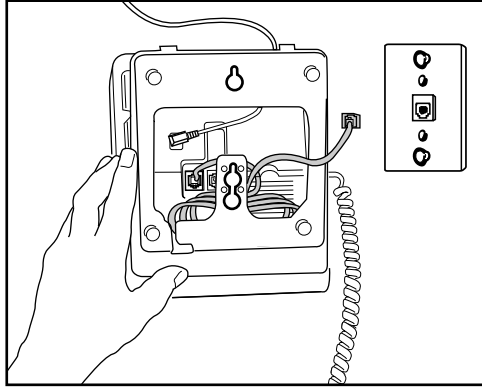

**For wall mounting, we recommend that you use a wall-mount plate. The excess line cord fits into the stand of the phone.**

## Checking your phone



When you plug in your 9009, you may see a message on the display asking you to make a language selection. Read the directions on the display to select one of two languages.

The phone also runs a test to ensure that the phone cord is connected properly. If the test fails, the display may prompt you to check the phone cord. Make sure that all connections are fastened securely. If the test passes, the message may stay temporarily, then disappear.

# Personalizing your phone

The 9009 has five options to personalize your phone. Move the sliding panel which is located below the display and press the SET OPTIONS key to see each of the choices. You can change any of the five options by following the change procedure at the bottom of the page.

## Options

- 1. Change the language**  
You have a choice of display messages in one of two languages.
- 2. Set the time and date**  
You can set the time and date. If you subscribe to Call Display/Caller ID, the current time and date are set automatically when the first call comes in. This also happens after a power failure.
- 3. Set the ring tone and ringer volume**  
You can choose one of four different ring tones. While you are selecting the ring tone, you can adjust the ringer volume by pressing the volume bar  below the dial pad. Use  to end only when you are satisfied with the ring tone and ringer volume.
- 4. Turn the light off**  
You can program a memory key to turn the light on and activate a feature at the same time. If you don't want the light on while the feature is active, use this option to turn the light off.
- 5. Enter your area code**  
When Call Display/Caller ID shows local calls, it may also show the area code. If you want local calls to appear without the area code, enter your area code using this option.

### To change any of the five options:

1. Don't pick up the receiver.



---

2. Slide the panel (located below the display) and press the SET OPTIONS key.

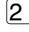
---

3. Press  to move through the list of options one at a time  
OR  
Press the desired option number on the dial pad.  
For example, when 5 items in list appears on the display, press  to set the time and date.

---

4. Press the selected option number again ( through ) , and follow the instructions on the display to change the option.

---

## Saving numbers and services in memory

After you have set up your phone, save the names and numbers of your customers, associates or anyone else you call frequently in the phone's memory. For easy access, you can also save feature codes for system services in memory.

### To save a number in memory:

1. Press **Save** and follow the instructions on the display.

OR For example, to save the number 555-1440 on a memory key:

1. Press **Save**.

2. Press the memory key where you want to save the number.

3. Use the dial pad to enter the number. In this case press **5 5 5 1 4 4 0**.

**Note:** If you require a pause, press **Hold** when you want the pause.

4. Press **Save**.

5. Write the name (in pencil) in the space provided on the receiver card.

### To erase the contents of a memory key:

1. Press the memory key to see its contents.

2. Press **#** twice to erase.

You can save access codes for system features in memory. You can store the ON feature code in one key and the OFF feature code in another. For example:

### To program a Call Forwarding ON key:

1. Press **Save**.

2. Press **1** to program the light to turn on.

3. Press the desired memory key.

4. Press the access code for turning the feature on (for instance **\*72** which may turn Call Forwarding **on**†).  
Read the display to confirm the number.

5. Press **Save** again.

6. Write Call Forwarding ON on the receiver card (in pencil).

### To program a Call Forwarding OFF key:

1. Press **Save**.

2. Press **0** to program the light to turn off.

3. Press the desired memory key.

4. Press the access code for turning the feature off (for instance **\*73** which may turn Call Forwarding **off**†).  
Read the display to confirm the number.

5. Press **Save** again.

6. Write Call Forwarding OFF on the receiver card (in pencil).

When you turn a feature on using a memory key, the 9009's light comes on to remind you that the feature is in use. When you turn the feature off using a memory key, your phone's light also turns off. The light can be programmed to work with only one feature at a time.





**Note:** To save ON and OFF keys for a feature without the light, omit step 2 from the above procedures.

†Codes may vary between PBX or Centrex systems and telephone companies.

# Using the 9009 features

## Protecting the contents of your memory keys

For security reasons, you can protect the contents of your memory keys by locking them. You will still be able to use your memory keys to place calls, but you will not be able to erase them or save new numbers while they are locked.

To lock your memory keys:	To unlock your memory keys:
1. Don't pick up the receiver.	1. Don't pick up the receiver.
2. Press the SET OPTIONS key.	2. Press the SET OPTIONS key.
3. Press  .	3. Press  .
4. Press  .	4. Press  .

## Placing a customer on hold

If you want to continue your conversation at another extension, press  and hang up the receiver. The hold feature keeps the caller on the line and is released once you pick up the extension telephone.

## Ensuring privacy

The 9009's light comes on and **Extension in use** appears on the display when another person in your office picks up an extension on your line. The light remains on until the other person hangs up. The 9009 telephone will sense most types of communication equipment connected to your telephone line.

## Controlling the ringer volume

While the telephone is ringing, you can press the left or right side of the volume bar  for soft or loud ringer volume. You can also adjust the ringer volume and tone in the SET OPTIONS list, as long as the ringer has not been turned off.

You can turn the ringer off by pressing the left side of the volume bar without lifting the receiver. **Ringer is OFF** may appear on the display unless another message has priority. Your phone still shows who is calling if you subscribe to Call Display/Caller ID. When you want to turn the ringer on, press the right side of the volume bar without lifting the receiver.

## Controlling the receiver volume

While you are using the phone, you can press the left or right side of the volume bar  for softer or louder receiver volume.

## Releasing a call

When pressed, the RELEASE (Rls) key releases the call you were on and provides you with a dial tone without replacing the handset.

## Pause Feature

You may add a pause by pressing the  key at any time while programming your memory keys. A pause should be used in any programming sequence that requires waiting for a second dial tone or a confirmation tone.

## Remembering the last incoming call

The 9009 automatically stores the number of the last person that called you whether you answered the call or not. Without lifting the receiver, you can view the telephone number of the last incoming call by pressing †.

## Light and display messages

### Using telephone company services

The 9009 can give you all the subscribed services that your telephone company offers, from Call Display/Caller ID to Message Waiting. Contact your local telephone company for more information.

### Knowing when you have a message

You don't have to wait until you pick up the receiver to know that a message is waiting. The 9009 works with your voice mail system. The light flashes and the display shows **Message waiting** after your voice mail has received a call. Ask your local telephone company or system administrator to find out how you can obtain message waiting services.

In addition to alerting you when another extension is in use, the light flashes when the telephone rings, a caller is on hold, or a message is waiting for you.

Light and Display		What it means
Extension in use	Light is on	Someone is using an extension on your line.
Feature is in use	Light is on	A feature such as Call Forwarding is activated.
Call is on hold	Light flashes quickly	A call is on hold.
Private number		Caller has requested that number be blocked.
Unknown Caller		Information is unavailable.
Long Distance		The call originates outside your local area.
Message Waiting	Light flashes slowly.	A voice message is waiting.
<		Call was forwarded from another location
Light flashes in time with phone's ring		Visual ringing: indicates an incoming call.

†Until you subscribe to Call Display or Caller ID, the number (and name, if available) of the call will not appear on the display. The name for this service may differ in your calling area.

# Answering your questions

## Display is in wrong language.

You can change to the other language by pressing the SET OPTIONS key and pressing **1** twice.

## Callers are not identified on the display.

Until you subscribe to Call Display/Caller ID, or until your Centrex system provides this service, your telephone will not receive the number (and name if available) of the caller. Also, you must let the phone ring twice before answering.

## Call Display shows: Unknown caller.

Information about the call is not available.

## While pressing \* to view last incoming call, display shows: Key is empty.

Until you subscribe to Call Display/Caller ID, or until your Centrex system provides this service, your telephone will not record the last incoming call.

## No dial tone. Check Phone cord may appear on the display.

Read the display. If the line cord is not attached properly, the display may prompt you. Make sure the receiver cord is attached securely. The message may stay for a while and then disappear.

## Telephone doesn't ring. Ringer is OFF may appear on the display.

The ringer volume may be turned off. Without lifting the receiver, press the right side of the volume bar,  to turn the ringer on again. You can adjust the ringer volume and tone in the SET OPTIONS list.

## No information appears on the display and the volume is low.

Make sure the power adaptor is plugged into a working electrical outlet. If the display only shows >\_, information about the call may be incomplete.

## Cannot hear a caller or be heard.

Make sure the receiver cord is inserted securely into the jack.

## Light stays on when a feature is not in use.

You can program a memory key to turn the light and a feature both on at the same time. If the light stays on, turn the light off by pressing the SET OPTIONS key and then pressing **4** twice.

## Cannot save or erase numbers in memory.

Your memory keys may be locked. Without picking up the receiver, press the SET OPTIONS key, press  and then press **#** to unlock.

## When you have a power failure

The 9009 will still operate as a regular telephone during a power failure, but the display will not operate until the power is restored.

# Index

## A

Area code, entering 6

## C

Call Display, obtaining 1

Call Forwarding

off key 7

on key 7

Caller ID, obtaining 1

## D

Date, setting 6

Discovery Card, attaching 4

## E

Erase, memory key 7

## F

Faceplate, attaching 3

Feature light, on and off 6

Features

hold 8

last incoming call 9

locking 8

memory 7

pause 9

privacy 8

release 8

unlocking 8

volume 8

## H

Hold

adding a pause in memory 7

putting a call on hold 8

releasing a call on hold 8

## I

Installation

desk-mount 2

Discovery Card 4

faceplate 3

lens 4

line cord 3

power adapter 3

receiver 2

Receiver Card 4

receiver cord 2

wall-mount 2

wall-mount plate 5

## L

Language, changing 6

Lens

installing 4

## M

Memory keys

erasing 7

labelling 7

locking 8

pausing 7, 9

saving numbers 7

saving services 7

unlocking 8

Messages, definitions 9

Mounting

desk 2

wall 2, 5

## O

Options

area code 6

date 6

language 6

ring tone 6

ringer volume 6

time 6

**P**

Privacy, ensuring 8

**R**

Receiver

attaching cord 2

volume setting 8

ReceiverCard,

installing 4

Release, a call 8

Ring tone, setting 6

Ringer volume

setting 8

Ringer volume,

setting 6

**S**

Services

saving in memory 7

telephone company

provided 9

**T**

Testing, phone 5

Time, setting 6

Troubleshooting 10

**V**

Volume

receiver volume 8

ringer 6

ringer volume 8

If you've read this owner's manual and consulted the "Answering your Questions" section and still have problems, please call 1-800-574-1611 for technical assistance.